

4-J1302

5' - 3"

2" C.I. (UND)

3" C.I.

1' - 0"

Permissible Const. Jt.

A1303 (Each Face)

A1302 (Each Face)

## SECTION THRU WING WALL

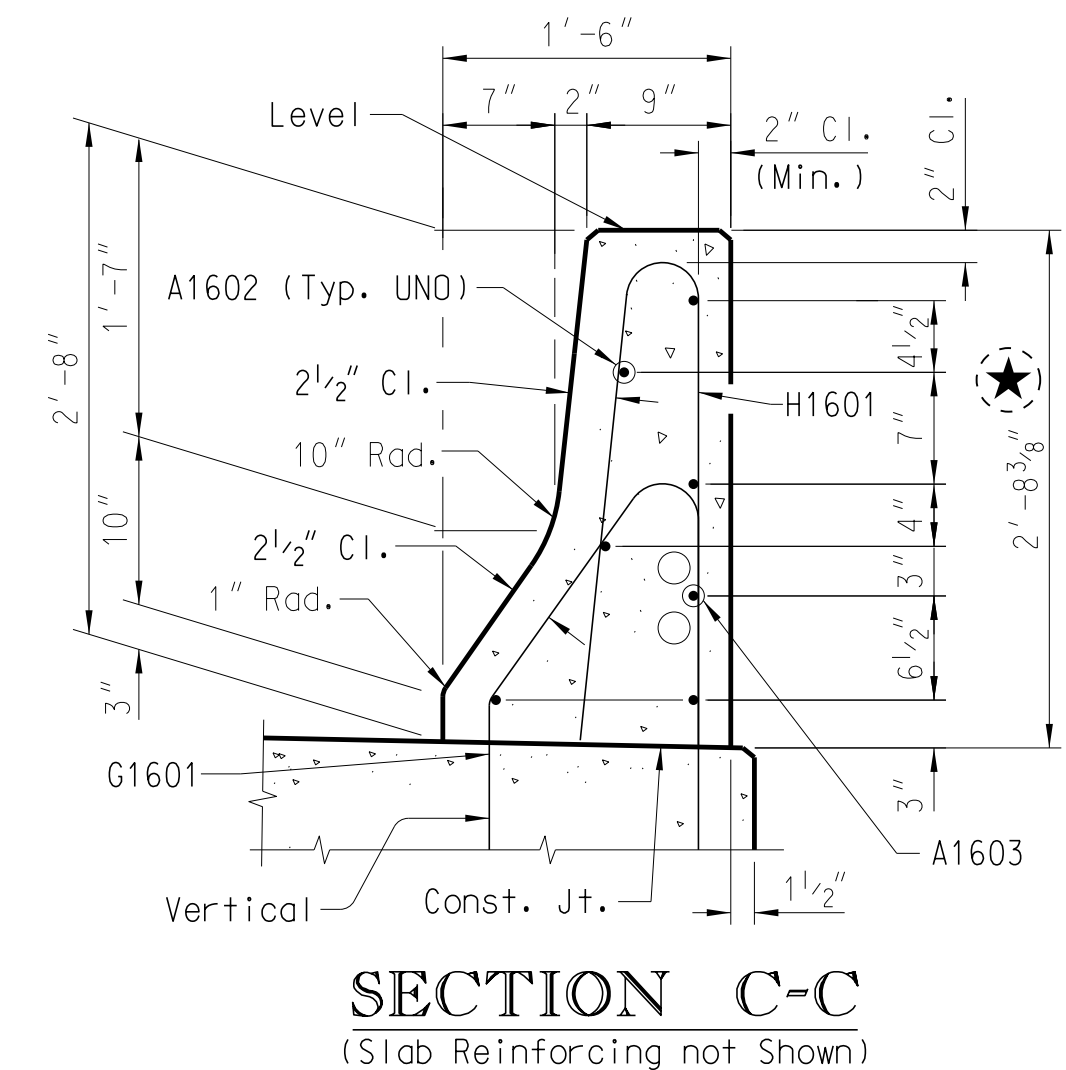

MARK	NO. REQ'D	DIMENSION				LENGTH
		"a"	"b"	"c"	"d"	
A1301	4	20'-2"	_____	_____	_____	20'-2"
A1302	12	2'-8"	_____	_____	_____	2'-8"
A1303	12	4'-9"	_____	_____	_____	4'-9"
A1601	65	36'-11"	_____	_____	_____	36'-11"
A1602	41	29'-8"	_____	_____	_____	29'-8"
A1603	4	7'-0"	_____	_____	_____	7'-0"
A2901	4	29'-8"	_____	_____	_____	29'-8"
A2902	71	26'-4"	_____	_____	_____	26'-4"
G1601	62	1'-7 1/4"	2'-6 3/4"	_____	_____	6'-9"
H1601	62	2'-3 7/8"	2'-3 1/2"	0'-7 3/8"	_____	5'-2"
J1301	42	0'-8"	1'-4"	_____	_____	3'-4"
J1302	8	0'-8"	4'-10"	_____	_____	10'-4"
SB	1" Ht.	As Necessary				
CHCU	12 1/2" Ht.	As Necessary				

ITEM	UNIT	30' END SPAN
Concrete, Class 4000	CY	67.2
Reinforcing Steel	LB	11,594
Barrier Parapet	LF	60.0
Elastomeric Bearing Assembly (Flat Slab)	EA	2

For Section thru Slab and Slab Drain Details, see Sh. XX.

② Detail the A1603 bars 7'-0" in length.

Note to Designer:

This drawing furnished for information only. All dimensions shown are sheet specific. Any use of this design and drawing, including dimensions, must be checked by the User's Engineer to ensure design is adequate for the intended use. All drawings must be signed and sealed by a South Carolina Registered Professional Engineer when used.

Dimensions shown are calculated for bridges with normal crown and  $SE = 0.0208 \text{ ft./ft.}$  Designer to revise dimensions for different geometry.

REV.				SOUTH CAROLINA DEPARTMENT OF TRANSPORTATION  30'-0" END SPAN  SUPERSTRUCTURE  (34'-0" ROADWAY)
REV.	PCW	LEM	2-18	
	MASH	Guardrail		
REV.	JXY	SAN	3-14	
		New Border		
REVIEWED				
QUAN.	MRW	PNP	1-10	
DR.	MRW	PNP	1-10	
DES.	MRW	BMH	1-10	
	BY	CHK.	DATE	COUNTY XXXXXXXX ROUTE XXXXXX

- LEGEND
- Continuous Reinforcement
  - Non-Continuous Reinforcement

- Notes:
- Provide drain pipes that are 6" nominal diameter Schedule 40 PVC Pipe meeting the requirements of ASTM D 1785 or 6" nominal diameter fiberglass pipe meeting the requirements of ASTM D 2996. Cement at least two lugs, of a size suitable to anchor the pipe, to the portion of the pipe embedded in the concrete slab. Include all costs of furnishing and placing drains in the unit price bid for Concrete for Structures, Class 4000.
  - 1/4" elastomeric bearing pad 60 Durometer hardness. Provide materials for elastomeric bearings that conform to Section 724 of the Standard Specifications. Provide a pad the same length and width of slab build-down. Place stock length pieces end to end provided that no individual piece is less than 6'-0" in length. Include all costs for furnishing and placing the pads in the unit price bid for Elastomeric Bearing Assembly (Flat Slab).
  - At  $\phi$  Bent.
  - Includes 1/4" Elastomeric Bearing Pad.
  - 3 eq. sp. = 1'-3 1/2"

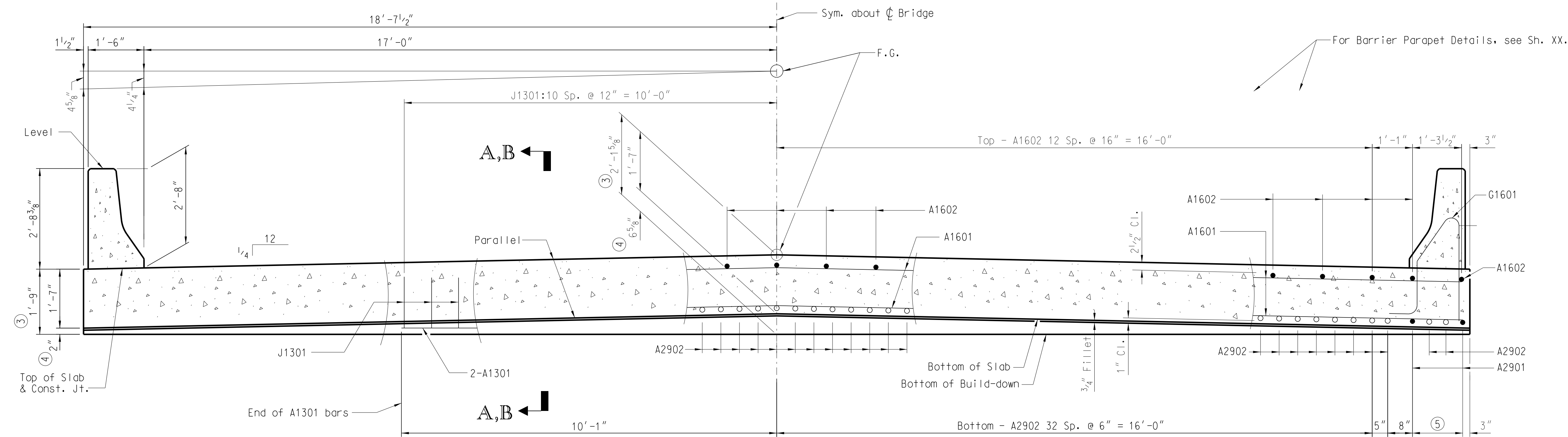

SECTION THRU 30' SPAN  
(Deck Drains Not Shown)

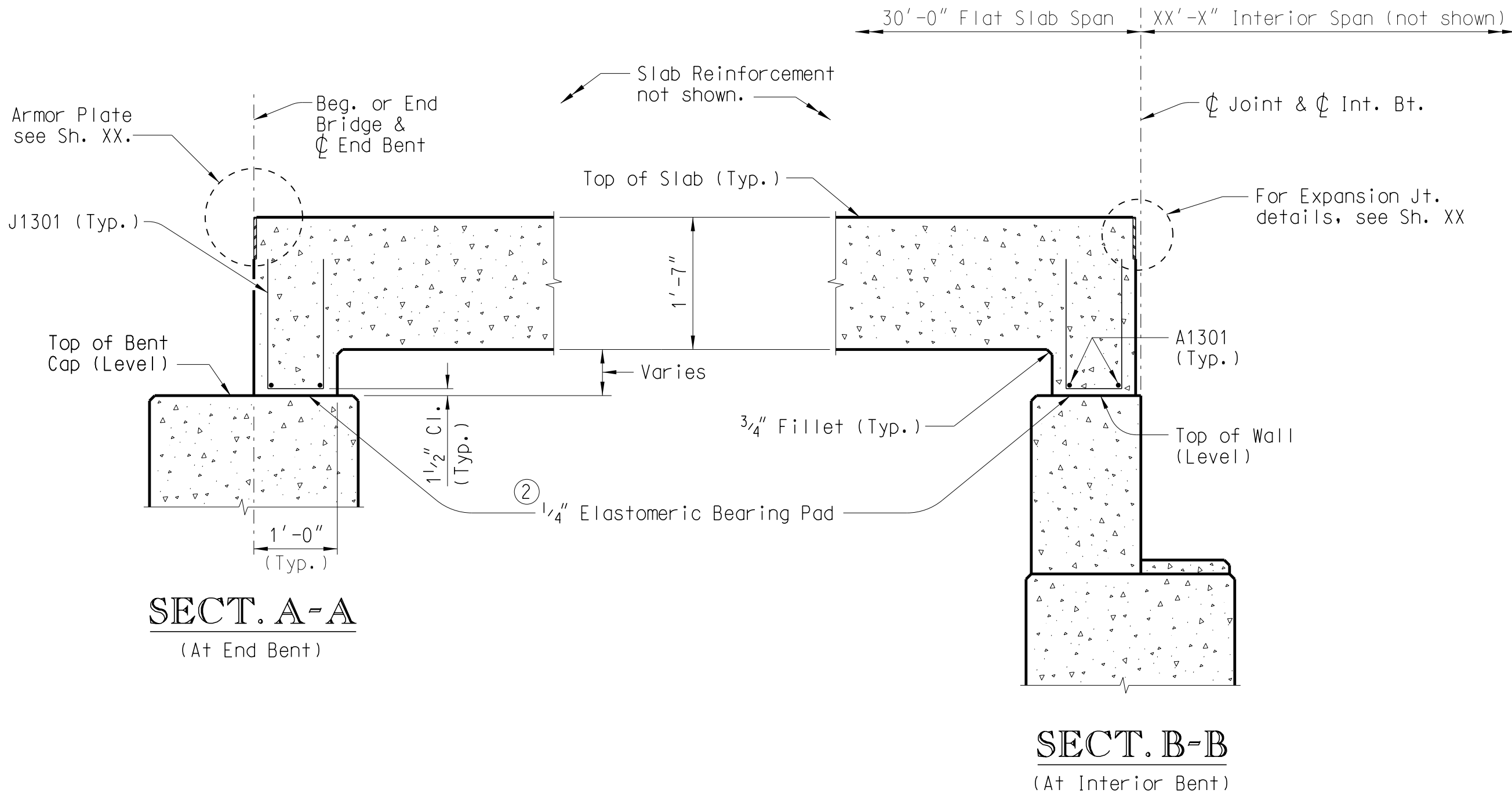

SLAB BUILD-DOWN DETAILS

ALTERNATES  
(Slab reinf. not shown)

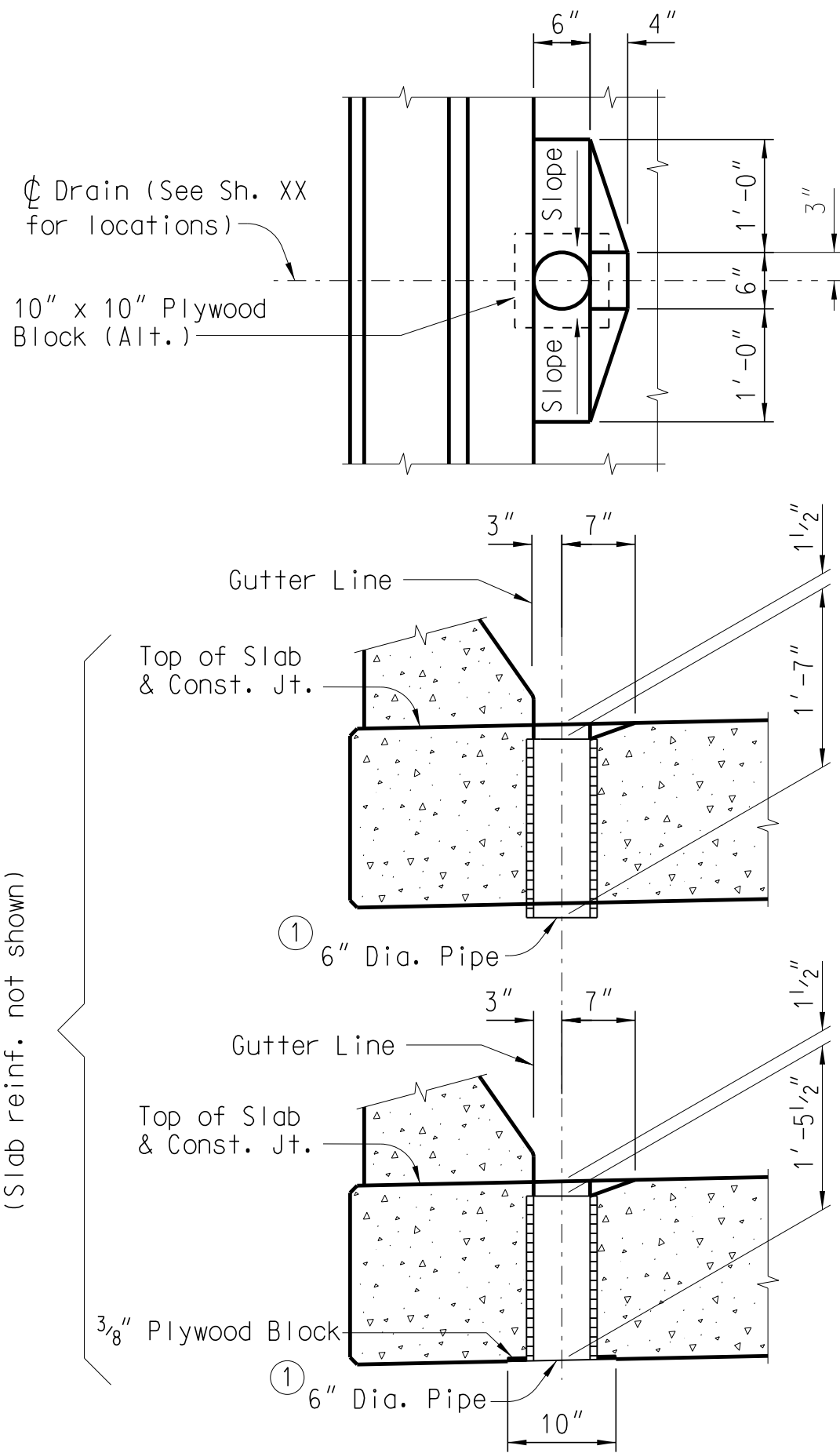

DRAIN DETAILS

Note to Designer:  
This drawing furnished for information only. All dimensions shown are sheet specific. Any use of this design and drawing, including dimensions, must be checked by the User's Engineer to ensure design is adequate for the intended use. All drawings must be signed and sealed by a South Carolina Registered Professional Engineer when used.

REV.				SOUTH CAROLINA			
REV.				DEPARTMENT OF TRANSPORTATION			
REV.				30'-0" END SPAN			
REV.				SUPERSTRUCTURE			
REV.				DETAILS			
REV.				COUNTY			
REV.				ROUTE			
REV.				DATE			
REV.				BY			
REV.				CHK.			
REV.				DATE			
REV.				DATE			
REV.				DATE			
REV.				DATE			
REV.				DATE			
REV.				DATE			
REV.				DATE			
REV.				DATE			
REV.				DATE			
REV.				DATE			
REV.				DATE			
REV.				DATE			
REV.				DATE			
REV.				DATE			
REV.				DATE			
REV.				DATE			
REV.				DATE			
REV.				DATE			
REV.				DATE			
REV.				DATE			
REV.				DATE			
REV.				DATE			
REV.				DATE			
REV.				DATE			
REV.				DATE			
REV.				DATE			
REV.				DATE			
REV.				DATE			
REV.				DATE			
REV.				DATE			
REV.				DATE			
REV.				DATE			
REV.				DATE			
REV.				DATE			
REV.				DATE			
REV.				DATE			
REV.				DATE			
REV.				DATE			
REV.				DATE			
REV.				DATE			
REV.				DATE			
REV.				DATE			
REV.				DATE			
REV.				DATE			
REV.				DATE			
REV.				DATE			
REV.				DATE			
REV.				DATE			
REV.				DATE			
REV.				DATE			
REV.				DATE			
REV.				DATE			
REV.				DATE			
REV.				DATE			
REV.				DATE			
REV.				DATE			
REV.				DATE			
REV.				DATE			
REV.				DATE			
REV.				DATE			
REV.				DATE			
REV.				DATE			
REV.				DATE			
REV.				DATE			
REV.				DATE			
REV.				DATE			
REV.				DATE			
REV.				DATE			
REV.				DATE			
REV.				DATE			
REV.				DATE			
REV.				DATE			
REV.				DATE			
REV.				DATE			
REV.				DATE			
REV.				DATE			
REV.				DATE			
REV.				DATE			
REV.				DATE			
REV.				DATE			
REV.				DATE			
REV.				DATE			
REV.				DATE			
REV.				DATE			
REV.				DATE			
REV.				DATE			
REV.				DATE			
REV.				DATE			
REV.				DATE			
REV.				DATE			
REV.				DATE			
REV.				DATE			
REV.				DATE			
REV.				DATE			
REV.				DATE			
REV.				DATE			
REV.				DATE			
REV.				DATE			
REV.				DATE			
REV.				DATE			
REV.				DATE			
REV.				DATE			
REV.				DATE			
REV.				DATE			
REV.				DATE			
REV.				DATE			
REV.				DATE			
REV.				DATE			
REV.				DATE			
REV.				DATE			
REV.				DATE			
REV.				DATE			
REV.				DATE			
REV.				DATE			
REV.				DATE			
REV.				DATE			
REV.				DATE			
REV.				DATE			
REV.				DATE			
REV.				DATE			
REV.				DATE			
REV.				DATE			
REV.				DATE			
REV.				DATE			
REV.				DATE			
REV.				DATE			
REV.				DATE			
REV.				DATE			
REV.				DATE			
REV.				DATE			
REV.				DATE			
REV.				DATE			
REV.				DATE			
REV.				DATE			
REV.				DATE			
REV.				DATE			
REV.				DATE			
REV.				DATE			
REV.				DATE			
REV.				DATE			
REV.				DATE			
REV.				DATE			
REV.				DATE			
REV.				DATE			
REV.				DATE			
REV.				DATE			
REV.				DATE			
REV.				DATE			
REV.				DATE			
REV.				DATE			
REV.				DATE			
REV.				DATE			
REV.				DATE			
REV.				DATE			
REV.				DATE			
REV.				DATE			
REV.				DATE			
REV.				DATE			
REV.				DATE			
REV.				DATE			
REV.				DATE			
REV.				DATE			
REV.				DATE			
REV.				DATE			
REV.				DATE			
REV.				DATE			
REV.				DATE			
REV.				DATE			
REV.				DATE			
REV.				DATE			
REV.				DATE			
REV.				DATE			
REV.				DATE			
REV.				DATE			
REV.				DATE			
REV.				DATE			
REV.				DATE			
REV.				DATE			
REV.				DATE			
REV.				DATE			
REV.				DATE			
REV.				DATE			
REV.				DATE			
REV.				DATE			
REV.				DATE			
REV.				DATE			
REV.				DATE			
REV.				DATE			
REV.				DATE			
REV.				DATE			
REV.				DATE			
REV.				DATE			
REV.				DATE			
REV.				DATE			
REV.				DATE			
REV.				DATE			
REV.				DATE			
REV.				DATE			
REV.				DATE			
REV.				DATE			
REV.				DATE			
REV.				DATE			
REV.				DATE			
REV.				DATE			
REV.				DATE			
REV.				DATE			
REV.				DATE			
REV.				DATE			
REV.				DATE			
REV.				DATE			
REV.				DATE			
REV.				DATE			
REV.				DATE			
REV.				DATE			
REV.				DATE			
REV.				DATE			
REV.				DATE			
REV.				DATE			